

**SIDEWIND MARINE SWIVEL JACK-ATWOOD**

Part #	Capacity (lbs.)	Description:	Bracket Height Retracted (in.)	Extended (in.)	Bracket	Repair Kit	Handle
AT87535	A	500 Atwood Side Wind Swivel Jack, Caster, Plated.	13.6"	23.9"	87501/87502	80454	
AT80057	A	1000 Atwood Side Wind Swivel Jack	11.3"	25.4"	87501/87502	80465	

**SIDEWIND MARINE JACK**

XP10	B	1200 Fulton Side Wind Bolt-On Swivel Jack Bolt Thru	12.75"	22.75"	included	0933302S00	0933301S00
EJ1000	C	1000 Eclipse Side Wind Bolt-On Swivel Jack Snap Ring	12.8"	22.8"	included		
CT28100	C	1000 Curt Side Wind Bolt-On Swivel Jack Snap Ring	12.75"	22.75"	included	28194	28913
XP15W0301	D	1500 Fulton Side Wind Swivel Jack Weld-On Bolt Thru W/ 8" Caster	13"	22.75"	P9012-00	0933306S00	0933305S00
XP10W	E	1200 Fulton Side Wind Swivel Jack Weld-On Bolt Thru	12.75"	22.75"	P9012-00	0933302S00	0933301S00

**SIDEWIND MARINE JACK-DUAL WHEEL**

F2W 141306-0334	F	1600 Fulton Side Wind Bolt-Thru Swivel w/Dual Wheel with Weld on Bracket 10" travel			included		
XPD15L	G	1500 Fulton Side Wind Bolt-Thru Swivel w/Dual Wheel	12.75"	24.75"	included	0933306S00	0933305S00
DL6800	H	1250 Dutton-Lainson Side Wind Bolt-On Swivel w/Dual Wheel	14"	26"	included		

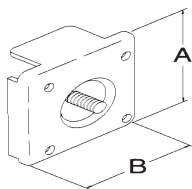

**P9012-00** - Weld-On Bracket w/ Large holes for New Style XP10W



**AT87501**



**AT87502**



**6811S00** - Replacement Caster

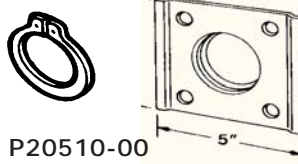

**P20510-00**  
**P9086-00**

**P20510-00** - Weld-On Snap Ring Bracket

**P9086-00** - Snap Ring

**AT87501** - Weld-On Bracket

**AT87502** - Bolt-On Bracket