

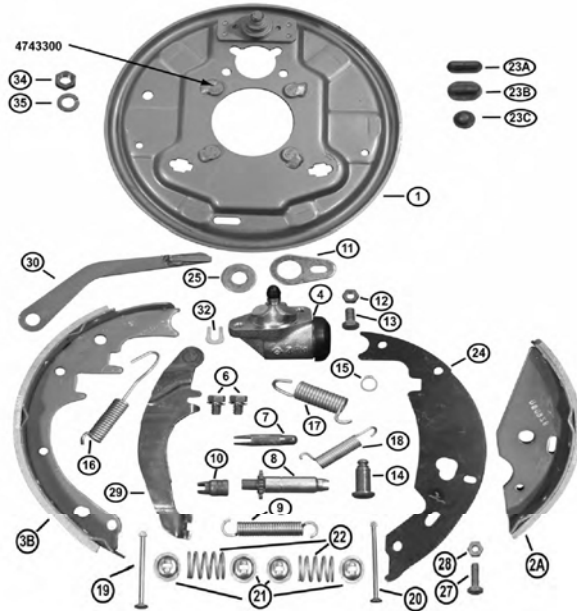

**10" x 2 1/4" Free Backing w/ Parking Brake Diagram**



**SB40716M LEFT HAND**  
**SB40715M RIGHT HAND**

*Parts List for Brake Diagrams*

Ref.	Part #	Description	Free-Back
1	24636	Back Plate	1
2A	17910	Front Shoe Assembly	1
3B	10953	Rear Shoe Assembly (BONDED)	1
4	9777	Wheel Cylinder Assy. —Left	1
5	9776	Wheel Cylinder Assy. —Right (SHOWN)	1
6	9778	Cap Screw & Lock Washer	2
7	9783	Push Rod	1
8	44375	Adjusting Screw Assembly	1
9	10957	Spring-Adjusting Screw	1
10	10956	Socket-Adjusting Screw	1
11	17917	Travel Link	1
12	17406	Hex Locknut 5/16 - 18NC (2-way)	1
13	7949	Hex Screw Cap 5/16 - 18NC x 5/8	1
15	7780	Retaining Pin	1
16	10958	Spring, rear shoe	1
17	9785	Spring—Lever	1
18	6814	Spring—Shoe	1
19	10959	Pin, shoe hold down	1
20	9788	Pin, shoe hold down	1
21	9789	Cup—Shoe Hold Down	4
22	10960	Spring, hold down	1
23A	24757	Plug, adjusting screw slot	1
23B	47446	Plug, parking brake	2
23C	47459	Plug, flush kit hole	1
24	47208	Shoe Lever	1
25	18950	Washer	1
27	10508	Bolt, 1/4" - 20 x 3/4"	1
28	40707	Lock Nut, 1/4 - 20	1

**10" x 2 1/4" Uni-Servo Brake Diagram**

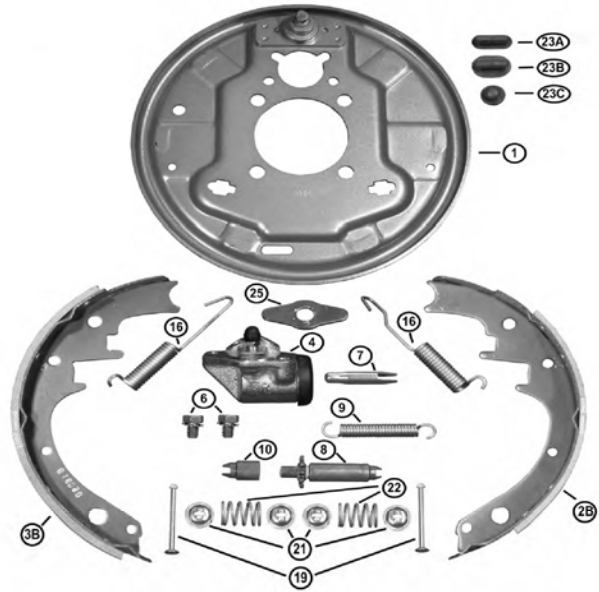

*Parts List for Brake Diagrams*

Ref.	Part #	Description	U-S
1	24636	Back Plate	1
2B	10952	Front Shoe Assembly	1
3A	10953	Rear Shoe Assembly	1
4	9777	Wheel Cylinder Assy. —Left	1
5	9776	Wheel Cylinder Assy. —Right (SHOWN)	1
6	9778	Cap Screw & Lock Washer	2
7	9783	Push Rod	1
8	44375	Adjusting Screw Assembly	1
9	10957	Spring-Adjusting Screw	1
10	10956	Socket-Adjusting Screw	1
16	10958	Spring, rear shoe	2
19	10959	Pin, shoe hold down	2
21	9789	Cup—Shoe Hold Down	4
22	10960	Spring, hold down	1
23A	24757	Plug, adjusting screw slot	1
23B	47446	Plug, parking brake	2
23C	47459	Plug, flush kit hole	1
26	44460	Shoe guide plate	1