



Forged Heavy Duty Pintle Hook



PH5
63013
 Capacity
 2,000 Lbs. Max. Vertical Load
 10,000 Lbs. Max. Gross Trailer Wt.



PH8 & PH15

P11C- PIN & CLIP

PH8

Capacity
 3,200 Lbs. Max. Vertical Load
 16,000 Lbs. Max. Gross Trailer Wt.

PH15 (CT48215)

Capacity
 6,000 Lbs. Max. Vertical Load
 30,000 Lbs. Max. Gross Trailer Wt.
 Drawbar Eye Dimensions
 2" to 3" I.D.
 w/ 1 1/4" To 1 5/8" Dia. Section



10,000 LBS

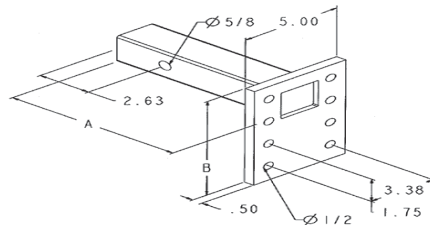

Pintle Hook Mounts

Part#	A (in.)	B (in.)	C (in.)	Pairs of Holes
PM 84	9.00"	3.75"	2.63"	2
PM 87	9.00"	7.38"	2.63"	4
PM 812	12.25"	12.50"	2.63"	7
PM 1012	14.50"	12.50"	2.63"	7

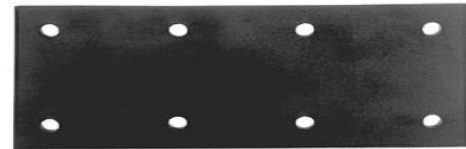

TNP716625750

Trailer Nose Plate

Predrilled nose plate is designed to accept the standard 4 1/2" square bolt pattern found on most drawbars. 3/4" thickness 7" X 16"
 Allows 3 mounting positions



PH45 (Replaces #580)
 18,000 lbs.
 Maximum Vertical Load
 70,000 lbs.
 Max. Gross Trailer Weight
 Drawbar Eye Dimensions
 2 3/8" to 3" I.D.
 Uses **8530** Mounting Kit

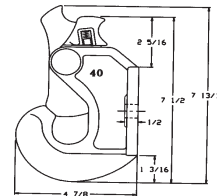
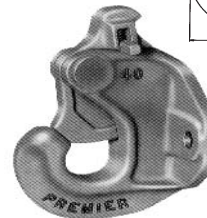

#40

Horizontal
 Tensile - 15,000 lb.
 Vertical
 Tensile - 2,250 lb.
 Min. Eye Opening - 2"

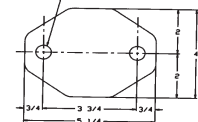

COMBO-HITCH



BH8-2000 (63011)
 -w/ 2" Ball
BH8-2516 (63012)
 -w/ 2 5/16" Ball
 16,000lbs MGTW
 3,000lbs Max Vertical Load

RB2000
 2" Replacement Ball
RB2516
 2 5/16" Replacement Ball
8520
 Buyers Grade 8 Mounting Kit

FITS 2" RECEIVER TUBE 5/8" PIN



Receiver Mount Combination
RM62000 2" BALL
RM62516 2 5/16" BALL
 12,000lbs MGTW
 2,400lbs Max Vertical Load



5 Ton Receiver Mount Pintle Hook
RM5P 10,000 MGTW
 2,000 lbs Max Vertical Load