

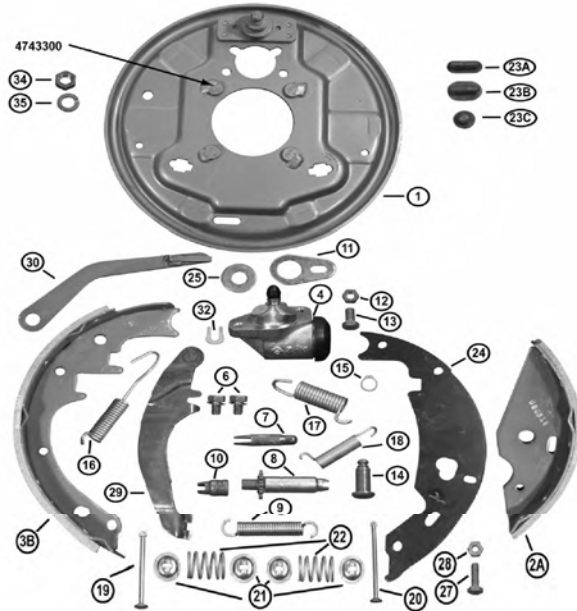

10" x 2 1/4" Free Backing w/ Parking Brake Diagram



40716 LEFT HAND
40715 RIGHT HAND

Parts List for Brake Diagrams

| Ref. | Part # | Description | Free-Back |
|------|--------|-------------------------------------|-----------|
| 1 | 24636 | Back Plate | 1 |
| 2A | 17910 | Front Shoe Assembly | 1 |
| 3B | 10953 | Rear Shoe Assembly (BONDED) | 1 |
| 4 | 9777 | Wheel Cylinder Assy. —Left | 1 |
| 5 | 9776 | Wheel Cylinder Assy. —Right (SHOWN) | 1 |
| 6 | 9778 | Cap Screw & Lock Washer | 2 |
| 7 | 9783 | Push Rod | 1 |
| 8 | 44375 | Adjusting Screw Assembly | 1 |
| 9 | 10957 | Spring-Adjusting Screw | 1 |
| 10 | 10956 | Socket-Adjusting Screw | 1 |
| 11 | 17917 | Travel Link | 1 |
| 12 | 17406 | Hex Locknut 5/16 - 18NC (2-way) | 1 |
| 13 | 7949 | Hex Screw Cap 5/16 - 18NC x 5/8 | 1 |
| 15 | 7780 | Retaining Pin | 1 |
| 16 | 10958 | Spring, rear shoe | 1 |
| 17 | 9785 | Spring—Lever | 1 |
| 18 | 6814 | Spring—Shoe | 1 |
| 19 | 10959 | Pin, shoe hold down | 1 |
| 20 | 9788 | Pin, shoe hold down | 1 |
| 21 | 9789 | Cup—Shoe Hold Down | 4 |
| 22 | 10960 | Spring, hold down | 1 |
| 23A | 24757 | Plug, adjusting screw slot | 1 |
| 23B | 47446 | Plug, parking brake | 2 |
| 23C | 47459 | Plug, flush kit hole | 1 |
| 24 | 47208 | Shoe Lever | 1 |
| 25 | 18950 | Washer | 1 |
| 27 | 10508 | Bolt, 1/4" - 20 x 3/4" | 1 |
| 28 | 40707 | Lock Nut, 1/4 - 20 | 1 |

10" x 2 1/4" Uni-Servo Brake Diagram

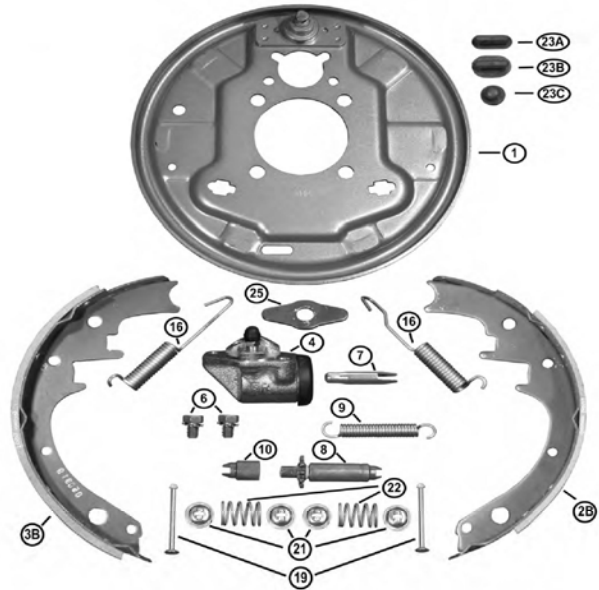

Parts List for Brake Diagrams

| Ref. | Part # | Description | U-S |
|------|--------|-------------------------------------|-----|
| 1 | 24636 | Back Plate | 1 |
| 2B | 10952 | Front Shoe Assembly | 1 |
| 3A | 10953 | Rear Shoe Assembly | 1 |
| 4 | 9777 | Wheel Cylinder Assy. —Left | 1 |
| 5 | 9776 | Wheel Cylinder Assy. —Right (SHOWN) | 1 |
| 6 | 9778 | Cap Screw & Lock Washer | 2 |
| 7 | 9783 | Push Rod | 1 |
| 8 | 44375 | Adjusting Screw Assembly | 1 |
| 9 | 10957 | Spring-Adjusting Screw | 1 |
| 10 | 10956 | Socket-Adjusting Screw | 1 |
| 16 | 10958 | Spring, rear shoe | 2 |
| 19 | 10959 | Pin, shoe hold down | 2 |
| 21 | 9789 | Cup—Shoe Hold Down | 4 |
| 22 | 10960 | Spring, hold down | 1 |
| 23A | 24757 | Plug, adjusting screw slot | 1 |
| 23B | 47446 | Plug, parking brake | 2 |
| 23C | 47459 | Plug, flush kit hole | 1 |
| 26 | 44460 | Shoe guide plate | 1 |